



TRANSPORTATION
SAFETY
INNOVATIONS

PRODUCT
AND REFERENCE
GUIDE

GREETINGS!



Products Service Knowledge

We practically chant it in our sleep.

Products, Service, and Knowledge are the essential elements and foundation upon which PPP operates. Since opening in

1996, we have been constantly improving these elements to better serve you, our customers.

At PPP, we are always on the lookout for trusted products to add to our catalog that provide the best value to you. If we can't find a product that meets your needs and our standards. We are continuously working to reduce friction points so we can serve you effectively and more efficiently. We routinely tweak our employee education program and work tirelessly to provide our customers with knowledge garnered through research, expert experience, and attending industry educational events. All of these efforts culminate in what we hope to be the best **Products, Service, and Knowledge** in our industry.

In addition, PPP is built on a foundation of faith. We truly believe that all that we receive and achieve is by the grace of God and should be used to glorify Him; we encourage our customers to hold us accountable to Christian values such as honesty, integrity, hard-work and fairness.

We appreciate the opportunity to serve you on your upcoming projects and in fulfilling your product needs.

Thank you for choosing PPP.

Sincerely,

Greg Driskell

President



FINDING US IS EASY!



9556 Historic Kings Rd. S., Suite #401
Jacksonville, FL 32257
Tel: 904.733.2121



Toll free
888.717.7771



Online
www.pppcatalog.com



E-mail
info@pppcatalog.com

TABLE OF CONTENTS

Retroreflectivity Assessments Solutions

| | |
|----------------------------------|-------|
| 1200k | 20 |
| 922 | 19 |
| 932 | 20 |
| Certified Test Panel | 21 |
| LaserLux G7 | 16-17 |
| Redimat | 5 |
| Stripemaster 1 Touch | 18 |
| StripeMaster 2 Touch | 18 |
| StripeMaster 2 Touch Color | 18 |
| <hr/> | |
| LaneAlert 2x | 13 |
| Modular Median | 6-7 |
| MedianAlert | 8 |
| Orca | 11 |
| PostAlert 2 | 14-15 |
| PostAlert 4 | 14-15 |
| RediMat Duo | 5 |
| Reflective Rumble Strips | 10 |
| SiteCop | 10 |
| SiteCop Plus | 10 |
| Technoflex Speed Bump | 12 |
| TraffiCop | 9 |

For your convenience, all of our products included in this catalog have been allocated for usage in the following categories where applicable.



Motorists



Pedestrian



Bicyclist



Visibility



Parking

PRODUCTS

At PPP we are always working towards creating new and innovative products to enhance the safety of our roadways.

Listed below you will find a comprehensive list and page number for our most Innovative Products.

| | |
|--|-------|
| RediMat Duo™ | 5 |
| Modular Median™ | 6-7 |
| MedianAlert™ | 8 |
| Traficop Modular Speed Cushions™ | 9 |
| Sitecop Modular Speed Cushions™ | 10 |
| Orca Lane Separator™ | 11 |
| LaneAlert 2x™ | 13 |
| PostAlert™ | 14-15 |

Retroreflectivity Assessment Solutions

| | |
|---|-------|
| LaserLux G7™ Mobile Retroreflectometer | 16-17 |
| StripeMaster Touch Series™ | 18 |
| 922 Retroreflectometer™ | 19 |
| 932 Retroreflectometer™ | 20 |
| RPM 1200K™ Reflective Pavement Marker Retroreflectometer | 20 |
| Certified Test Panel™ | 21 |



See our full catalog and
shop PPP online 24/7 at
www.pppcatalog.com

DETECTABLE WARNING SURFACE

RediMat™



RediMat™

RediMat™ surface-applied detectable warnings provide an easy yet durable solution for retrofit applications. The RediMat™ does not require adhesives to apply, conforms to uneven surfaces, and is unbreakable. All sizes available in Safety Yellow, Brick Red, and Black.

Detectable Warning Systems, Inc.

Standard Sizes

I2-10-1-2424 24-in. x 24-in.

I2-10-1-2436 24-in. x 36-in.

I2-10-1-2448 24-in. x 48-in.

I2-10-1-2460 24-in. x 60-in.

I2-10-1-3630 36-in. x 30-in.

I2-10-1-3648 36-in. x 48-in.

Radius Wedge Mats

I2-10-1-2427 24-in. x 27-in. Wedge

RediMat™ Edgesealer I2-10-1-ES

RediMat™ Roller I2-10-4



RediMat Roller™ & Edgesealer



RediMat Duo™

The original uniquely branded detectable warning system by **Detectable Warning Systems, Inc.**

The RediMat Duo™ is a detectable warning 2-mat system with a message. Providing either a custom or standard message, the RediMat Duo™ is easily adaptable to most applications. The custom 2-color message accommodates slogans, logos, or popular characteristics of the city, school or business. While the standard 2-color messages provides warning, information or guidance to sighted pedestrians. The 2-mat system of the RediMat Duo™ provides meaningful messages to the sighted and distracted pedestrians.

Features:

- Effective design and field-tested features of the RediMat™
- Provides meaningful messages to the sighted
- Custom 2-color slogan, logo, mascot or popular characteristic of the city, county, state, school or business*
- Standard 2-color messages that provide warning, information or guidance to sighted pedestrians
- Proprietary CleanCut™ process flawlessly creates your message on two mats
- Full depth color of the components resisting wear or fading of the message
- Two distinct 2-color detectable warning mats communicating your message

**Note limitations exist on complex art.*

Colors

Custom colors are available but require minimum quantity orders



Safety Yellow



Brick Red



Black

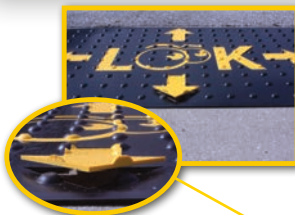

RediMat Duo - 2X4 Black & Yellow-I2-10-1-2448-RMD-BY

TRAFFIC MANAGEMENT



RediPave Modular Median™



The RediPave Modular Median™ is an innovative modular system designed for the safe, smart, and simple creation of refuge islands and build-outs. As a modular system, different shapes can be made to suit almost any application; making it a safe, smart, and simple device for motorists, pedestrians, and bicyclist.

by **RediWeld**

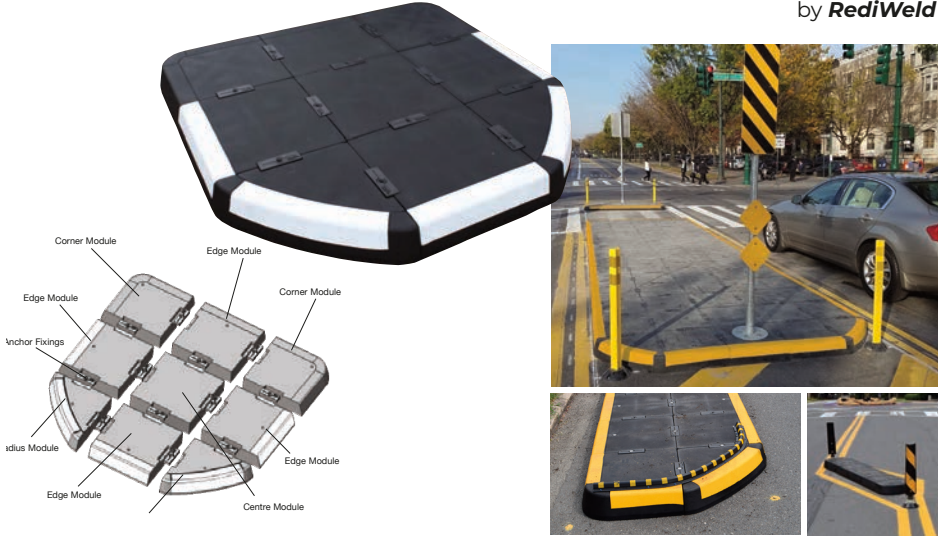

Safe

- Improve pedestrian safety with median refuges and crossing build-outs and other pedestrian-friendly configurations
- Manage traffic safety with chokes, chicanes and island layouts
- Ensure worker safety with fast installation requiring less time in travel-ways



Smart

- Made of durable recycled rubber polyurethane composite for extended life
- Modular system that allows multiple configurations for most any application
- Proprietary anchoring system that ensures secure, removable, minimum maintenance attachment to the roadway



Simple

- Fast install with three-man crew
- No heavy equipment required
- Installs in hours, not days

Customizable Configurations
For most any traffic management need

Durable Composite Modules
Long life even in tough roadway environment

Simple Installation
Minimum labor and no heavy equipment

Community Friendly
Limited install disruption, improves neighborhood safety



TRAFFIC MANAGEMENT

RediPave Modular Median™

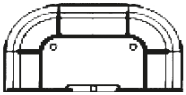

Splitter End
#I2-8-12-RPS-E

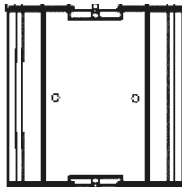

Splitter Middle
#I2-8-12-RPS-C

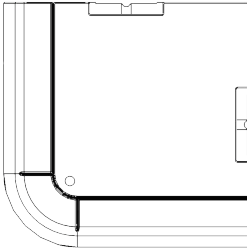
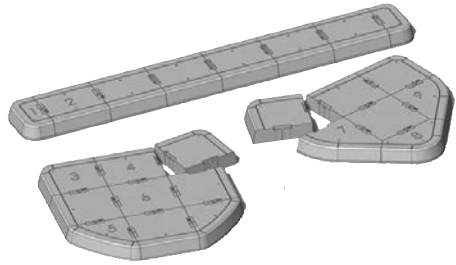

Corner
#I2-8-12-RPI-CO (Yellow)
#I2-8-12-RPI-CO-W (White)

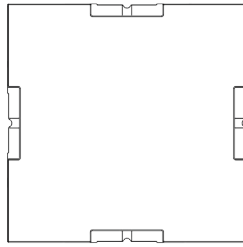

Middle
#I2-8-12-RPI-C

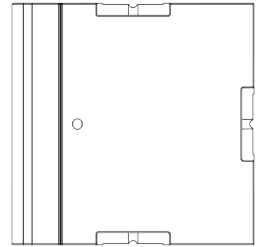

Edge
#I2-8-12-RPI-E (Yellow)
#I2-8-12-RPI-E-W (White)

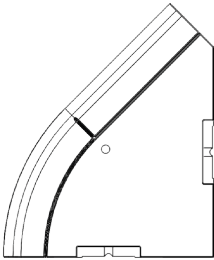

Left Corner
Non-Stock

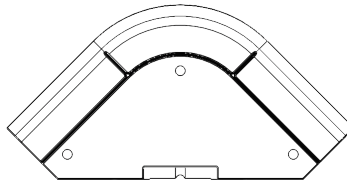

Bull Nose
Non-Stock

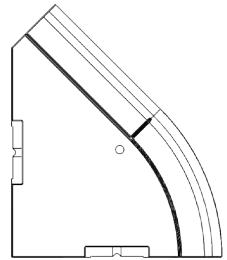

Right Corner
Non-Stock

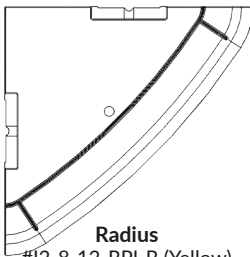

Radius
#I2-8-12-RPI-R (Yellow)
#I2-8-12-RPI-R-W (White)

Anchor Block Set

Anchor Block
150 mm L x 50 mm W x 30 mm H
#I2-8-12-RP-1H-AB



Torx Screw
M10 x 240 mm
#I2-8-12-RP-1H-TS

Edge Anchor Set

Black Nylon Washer
Used on Edge Screws
30 mm Diameter
#I2-8-12-RP-1H-BW



Torx Screw
M10 x 240 mm
#I2-8-12-RP-1H-TS

Redi Plug
#I2-8-12-RP-1H-RP

TRAFFIC MANAGEMENT

The ORCA Lane Separator™

improves the safety of pedestrians, cyclists, and motorists. The Orca Lane Separator™ is used for lane control and separation. The Orca Lane Separator™ features curbing, flexible posts, and retroreflective materials. The Orca Lane Separator™ is the safe, smart, simple lane separator.



Safe

- Effectively directs and channelizes motorists and cyclists
- Imolded high-visibility traffic markings and retroreflective reboundable posts for nighttime visibility
- Structural size, shape, and design regulates lane usage and protection



Smart

- Configure intermittently spaced sections or continuous curb for both longitudinal and lateral control
- Proven secure anchoring system for extended useful life
- Versatile use in both vehicular and bicycle travel ways



Simple

- Fast install with a three-man crew
- No heavy equipment required
- Installs in hours, not days

Safer Roads, LLC



Durable Composite Modules

Long life, even in tough roadway environments

Simple Installation

Minimum labor and no heavy equipment

Community-Friendly

Limited install disruption, improves neighborhood safety



Orca Light Dome Bung-I2-8-10-3-O-LDB

Wand "ORCA" End Module White w/Glass Beads.

Includes 3 Lag Bolts, 3 Rediplugs, and 3 Washers-I2-8-10-3-OE-W

Wand "ORCA" End Module YELLOW w/Glass Beads.

Includes 3 Lag Bolts, 3 Rediplugs, and 3 Washers-I2-8-10-3-OE-Y

Wand "ORCA" Middle Module White w/Glass Beads.

Includes 4 Lag Bolts, 4 Rediplugs, and 4 Washers-I2-8-10-3-OM-W

Wand "ORCA" Middle Module YELLOW w/Glass Beads.

Includes 4 Lag Bolts, 4 Rediplugs, and 4 Washers-I2-8-10-3-OM-Y

ORCA Pole Cone with Ground Anchor & Sleeve-I2-8-10-3-OPC

ORCA Pole Cone with Ground Anchor & Sleeve,

Orange W/White Refl Sheeting-I2-8-10-3-OPC-OW

TRAFFIC MANAGEMENT

FEATURE

PRODUCT

MedianAlert™



The MedianAlert™ is designed to dramatically improve the nighttime visibility of medians and other roadway structures.

The MedianAlert™ is used when medians and other fixed structures are used in the roadway system for lane division and access control. Such roadway structures, if not adequately visible to the motorist, can potentially present hazards to both the motorists and pedestrians.

The MedianAlert™ can improve the safety of median structures for:

- Traffic circles
- Pedestrian refuges
- Turn lanes
- Turn drop lanes
- Intersections
- "Tee" intersections
- Interchange
- Transitions
- Channelizations
- Concrete barrier walls
- Physical gores and other areas where curbs, islands or medians are present

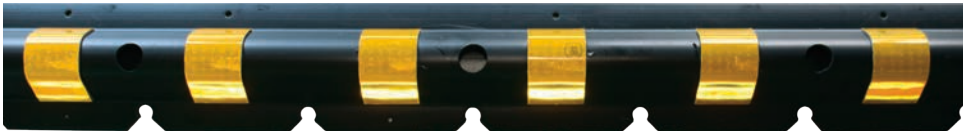

Safe

- As a horizontal delineator, the MedianAlert™ provides a clear, distinct visual cue of the median's width to motorists
- Utilizes retroreflective directional engineering to provide delineation without distraction
- Low-profile, reboundable structure reduces damage to device and vehicle during impact



Simple

- Secure installation with both mechanical and adhesive fastening systems
- Fast and easy install in less than 15 minutes
- Durable structure and attachment design, requiring little to no maintenance



Smart

- Independent visual system with dynamic effect that requires no power or maintenance
- Innovative UV-resistant PVC compound withstands wide temperature ranges
- Flexible, elongated design can adapt to many radiuses
- Environmentally-friendly, containing more than 50 percent post-industrial waste

White 4-FT-2-8-8-1W

Yellow-4-FT I2-8-8-1Y

Tapcon Screws

I2-8-8-1-STA-17 17-pcs

PK of 3/16 x 1 1/4 to anchor 4-ft Median Alert

I PVC Connector

**2-8-8-1-C 1/2" x 5"
(1 Per 2 MA)**



*PostAlert™ also available.
See page 12 for details.*

TRAFFIC MANAGEMENT

FEATURE



PRODUCT

PostAlert™



Government agencies continue to recognize the important correlation between the retroreflectivity of roadway signs and roadway safety. There are millions of signs on our roadways and they all play a vital role in keeping motorists safe. While all roadway signs are important, some are of more importance than others and need to be emphasized. The PostAlert™ is a simple way to place emphasis on an important or partially obstructed sign. The PostAlert™ draws extra attention from motorists, making it a safe, smart, simple life-saving device.



*Shown here with
MedianAlert™*

MedianAlert™ also available. See page 8 for details.

4-In. Dia., 6-Ft. PostAlert Left Diagonal - Fluorescent-I3-2-5-46-LDFYG

4-In. Dia., 6-Ft. PostAlert Left Diagonal - Orange-I3-2-5-46-LDO

4-In. Dia., 6-Ft. PostAlert Left Diagonal- Red-I3-2-5-46-LDR

4-In. Dia., 6-Ft. PostAlert Left Diagonal - White-I3-2-5-46-LDW

4-In. Dia., 6-Ft. PostAlert Left Diagonal - Yellow-I3-2-5-46-LDY

4-In. Dia., 6-Ft. PostAlert Right Diagonal - Fluorescent-I3-2-5-46-RDFYG

4-In. Dia., 6-Ft. PostAlert Right Diagonal - Orange-I3-2-5-46-RDO

4-In. Dia., 6-Ft. PostAlert Right Diagonal - Red-I3-2-5-46-RDR

4-In. Dia., 6-Ft. PostAlert Right Diagonal - White-I3-2-5-46-RDW



TRAFFIC MANAGEMENT

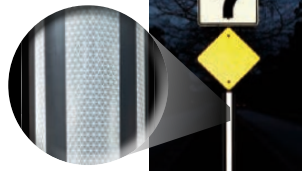
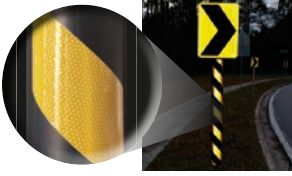

Safe

- The PostAlert™ protects pedestrians and motorists at school crossings, highway entrance and exit ramps, high risk intersections and mid-block crossings
- Provides visibility and conspicuity for traffic signs and their posts- regardless of the time of day or the direction of vehicle approach
- Unique radius design provides visibility in excess of 180 degrees



Smart

- All PostAlerts™ are designed to be quickly and easily installed to virtually any post type in one to five minutes
- The PostAlert™ 4 has three pre-drilled holes that match up to pre-punched u-channel and square posts
- The PostAlert™ 2 has industrial-strength peel and stick permanent adhesive for attachment to any post



Simple

- The black base of the PostAlert™ creates significant contrast with any of the retroreflective material colors to positively affect daytime visibility
- Heavy-duty and innovative HDPE construction results in years of effective life for most roadway applications and environmental conditions
- Multiple colors, sizes, and marking configurations ensures a clear and concise message to motorists



4-In. Dia., 6-Ft. PostAlert Right Diagonal - Yellow-I3-2-5-46-RDY

4-In. Dia., 6-Ft. PostAlert Vertical - Fluorescent I3-2-5-46-VFYG

4-In. Dia., 6-Ft. PostAlert Vertical - Orange-I3-2-5-46-VO

4-In. Dia., 6-Ft. PostAlert Vertical - Red-I3-2-5-46-VR

4-In. Dia., 6-Ft. PostAlert Vertical - White-I3-2-5-46-VW

4-In. Dia., 6-Ft. PostAlert Vertical - Yellow-I3-2-5-46-VY

2-In. Dia., 6-Ft. PostAlert Vertical - Red-I3-2-5-2R

2-In. Dia., 6-Ft. PostAlert Vertical - White-I3-2-5-2W

2-In. Dia., 6-Ft. PostAlert Vertical - Yellow-I3-2-5-2Y

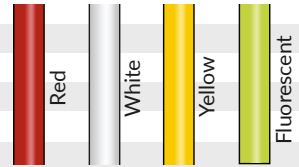

PostAlert™ 2 (2-in. width) 5-ft. length



TRAFFIC MANAGEMENT

FEATURE



PRODUCT

TRAFICOP Modular Speed Cushions



Configurable to varying widths & depths



Installation Tool Kit

Traficop Speed Cushion™

The ultimate traffic management device. With 15 years of experience and over 25,000 successful installations, you can count on the Traficop™ to provide a premium, long-lasting, low-maintenance, modular speed cushion that is also emergency vehicle friendly. Best for reducing speeds to 20-25 mph

- Modular design ensures correct and consistent ramp gradient and overall height, yet allows for customization for variable road sizes and applications
 - Quick and easy installation on any sound road surface without the need for excavation or road closures
 - Slows traffic but allows straddling by the wide wheel base of emergency vehicles
 - The Traficop™ is the only modular speed cushion that is solid from top to bottom and is made from recycled rubber from the tread of truck tires, the hardest-wearing part
 - With 58 anchor points and a galvanized steel reinforcing bar, the Traficop will not push, shift or shear, avoiding costly maintenance and repair
- Safer Roads, LLC**

Traficop Speed Cushion™

I2-8-10-1

Traficop Speed Cushion™ with Arrow

I2-8-10-3

Traficop™ Installation Tool Kit

I2-8-10-TOOLKIT

TRAFFIC MANAGEMENT



Sitecop™ & Sitecop Plus™

Speed Reduction Systems

The perfect alternative to the typical asphalt speed bumps, the Sitecop™ and Sitecop Plus™ offer a unique combination of features to meet a wide range of speed reduction management applications. Modular design adds application versatility and can be configured to be emergency vehicle friendly. The lightweight modules are manufactured from hard-wearing rubber that will look better and last longer than asphalt speed bumps. In molded reflective markings offer permanent high visibility. Effective for commercial parking lots and garages, lower speed roads, or perimeter roads surrounding shopping malls.

The Sitecop™: reducing speeds to 5-10 mph

The Sitecop Plus™: reducing speeds to 10-20 mph

Can be configured to varying widths



Sitecop™ Speed Bump
(Standard Layout-Complete Set)
I2-8-11-SC

Sitecop Plus™ Speed Bump
(Standard Layout- Complete Set)
I2-8-11-SCP



Safer Roads, LLC

Individual pieces of the Sitecop™ and SitecopPlus™ are available for creating variable installation lengths. Please ask your representative for assistance in planning your traffic management system.

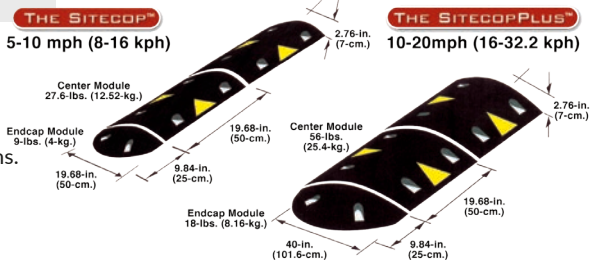

TRAFFIC MANAGEMENT

LaneAlert 2x™ Availability To Be Announced

**NEW
PRODUCT**

The LaneAlert 2x™ is an innovative counter measure to wrong way driving. This technologically advanced bidirectional pavement marking provides a single directional, clear, concise message to motorists in conditions most prone to wrong way driving.

From expressway interchanges to suburban and rural divided highways, to one-way urban streets, wrong-way driving is the most deadly accident type and steals the lives of thousands of fathers, mothers, sisters and brothers around the world every year.

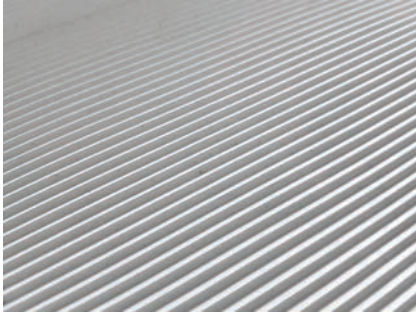

Proper approach view

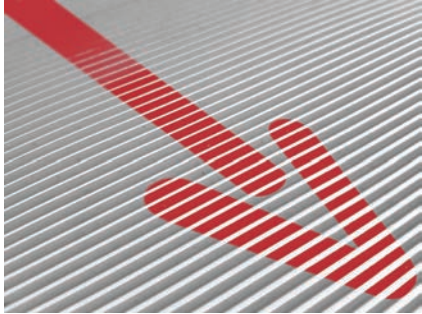

Improper approach view



Safe

- Provides a clear, concise message to wrong way motorists without distracting the right way motorist.
- Designed to provide the wrong way message in a way that most matches the impaired or aged motorist's viewing habits, the most at risk motorists.
- Use on roadways, bike lanes and even pedestrian ways, improving the safety of motorists, cyclists and pedestrians.



Smart

- Static device with dynamic functionality. A device with no mechanical or electronic dependency. But, dynamically changes its visual form depending on the direction of approach.
- Innovative profile and coating process that ensures the right message gets to the right motorist
- Durable polymeric compound structure ensures extended effective life cycle.



Simple

- Versatile and economical solution that can be implemented in most any environment. Regardless of the roadway type or agency budget.
- Easy, familiar method of installation.



LaneAlert 2x™ is designed to counteract the most common factors in Wrong Way driving:

Roadway Designs:

- Complex Expressway Interchanges
- Divided Suburban & Rural Highways
- One-Way Urban Streets

Driver Impairments:

- Age
- Fatigue
- Alcohol/Drug

Environmental Elements:

- Nighttime
- Rain
- Fog

RETROREFLECTIVITY ASSESSMENT SOLUTIONS

SMT Hand-Held Retroreflectometer

StripeMaster Touch™ Series

Pavement markings are one of the single most important infrastructure elements to a roadway's safety; they provide guidance, direction and warning to the motorists and pedestrians that use the roadway system. Retroreflectivity provides motorists with nighttime visibility of these pavement markings. The StripeMaster Touch™ Series of hand-held pavement marking retroreflectometers provides agencies and contractors with advanced, reliable, efficient, and effective means of assessing this visibility.

From simple retroreflectivity verification to total pavement marking asset management, the StripeMaster Touch™ Series has the right device for most applications.

Some of the many common features of this series include the StripeMaster's proven ultra-accurate optics for reliable measurement, user-friendly color touch screen for easy operation, ergonomic upright design for increased visibility, ease of operation, compact design, and protective case for transport. **RoadVista**



Safe

- Upright safety color yellow design makes operator more visible to motorists
- Swivel handle allows operator to control from ideal position
- Fast place, shoot and measure operation gets the operator in and out of traffic quickly
- Optics are proven ultra-accurate reliability

- Facilitates multiple ASTM testing methods and effectively meets the need for retroreflectivity verification methods
- Reliably measures retroreflectivity with proven optics and field durability
- Upgradeable full asset management features



Smart

- Firmware performs instant, reliable measurements and calculations



Simple

- Easy operation from virtually any hand-held device or computer
- Adapts to nearly any vehicle in minutes
- Easy data storage and transfer through USB flash drive

COLOR LCD TOUCH SCREEN

Intuitive software and user interface with full-color touch screen navigation and weather shield



AFFORDABLE RETROREFLECTIVITY

The SMT Series units are equipped with the most advanced features for field measurement of pavement markings



ESSENTIAL DATA COLLECTION

Fast, precise retroreflectivity measurements with accurate Global Positioning System (GPS) and on-site data reporting with built-in printer



StripeMaster 2 Touch™ Retroreflectometer I2-9-7-4A

StripeMaster 2 Touch™ Retroreflectometer RENTAL - RI2-9-7-4A

StripeMaster 1 Touch™ Retroreflectometer I2-9-7-4-SM1T

StripeMaster 2 COLOR™ Retroreflectometer I2-9-7-4-SM2T

RETROREFLECTIVITY ASSESSMENT SOLUTIONS

LASERLUX™ G7 Mobile Retroreflectometer



Government agencies continue to recognize the important correlation between pavement markings' retroreflectivity and roadway safety. These agencies are embarking on the challenge of assessing and managing the pavement markings of their entire roadway system. The Laserlux™ G7 is the safe, smart and simple solution to meet this challenge. By **RoadVista**



Safe

- No static work zones that create accident-prone traffic for motorists and allows the operator to be more visible to motorists
- No feet on the street, eliminating the need for workers being in harm's way
- Continuous assessment and measurement, ensuring no line is left behind



Simple

- Comprehensive data including retroreflectivity, contrast, line width, location, RPM count, and much more
- Auto-positioning system for continuous measurement and geometry management
- Easy operation from virtually any hand-held device or computer
- Adapts to nearly any vehicle in minutes
- Easy data storage and transfer through USB flash drive



Smart

- Proven laser-based optics that scan the markings up to 400 times per second

SQUID-MOUNT™

Securely attaches to virtually any vehicle



WI-FI WIRELESS OPERATION

From any handheld device or computer



NIGHTTIME COLOR MANAGEMENT

Optional ability to assess nighttime color

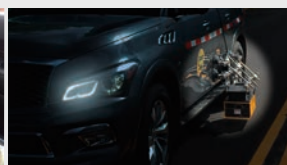

PROVEN LASER-BASED OPTICS

Scans pavement markings up to 400 times per second



LASERLUX™ G7

RoadVista

Measures retroreflectivity, contrast and Infrared for both human and machine vision.



Made & Serviced in the U.S.A.!



RETROREFLECTIVITY ASSESSMENT SOLUTIONS



LLG7 Mobile Retroreflectometer System - I2-9-7-5

LLG7 Alarm - I2-9-7-5-10A

LLG7 7" Foam Block - I2-9-7-5-10FB

LLG7 10-in SM Vacuum Cup - I2-9-7-5-10VC

LLG7 10-in SM Vacuum Cup w/ Audio Alarm - I2-9-7-5-10VCA

LLG7 6-in SM Vacuum Cup - I2-9-7-5-6VC

LLG7 CASE WITH FOAM AND DECAL - I2-9-7-5-C

LLG7 COLOR UPGRADE - I2-9-7-5-CU

DEMO Laserlux G7 Mobile Retroreflectometer System - I2-9-7-5-DEMO

LLG7 Anti-Reflective Acrylic/Plexiglass Window - I2-9-7-5-FG

LLG7 Poly Carbonate Front Window - I2-9-7-5-FW

LLG7 Matthews 2 1/2 Hollywood Head - I2-9-7-5-MHH

LLG7 Metal Protective Cover - I2-9-7-5-MPC

LLG7 POWER CORD - I2-9-7-5-PC

LLG7 6-in SIDE-FEED PAD - I2-9-7-5-SFP

LLG7 304 Stainless Round Tube .083 T X 5/8 OD X .5 - I2-9-7-5-ST.5

LLG7 304 Stainless Round Tube .083 T X 5/8 OD X-1 - I2-9-7-5-ST1

LLG7 304 Stainless Round Tube .083 T X 5/8 OD X-2 - I2-9-7-5-ST2

LLG7 5/8in Baby Spud w/ 3/8-16 Threaded Hole in Bs - I2-9-7-5-STEM

LLG7 Mobile Retroreflectometer Color System - I2-9-7-5C



RETROREFLECTIVITY ASSESSMENT SOLUTIONS

FEATURE



PRODUCT

922 Hand-Held Retroreflectometer



The MUTCD minimum sign retroreflectivity requirements presents a challenge to all agencies. The 922's smart, field-proven technology delivers a simple, economic solution for improving and maintaining the safety of your roadways by providing a zero-error means of meeting the minimum retroreflectivity of the MUTCD. Agencies using the 922 can accurately identify signs needing replacement, and just as important, identify the signs that do not need replacement.

RoadVista



Safe

- The safe solution with its exclusive annular optics, providing accurate, instant measurement from all directions in each reading
- Reduces a worker's time in the roadway, while offering a zero-error method of meeting the MUTCD retroreflectivity requirements, which ensures adequate night time visibility of signs by motorists



Smart

- The smart solution with its superior light source, annular optics, multi-channel GPS, barcode reader, and commercial-grade rechargeable battery, brought together in the 922's compact, field-proven, 6 lb ergonomic, lightweight casing



Made & Serviced
in the USA!



Simple

- The simple solution, automatically recording 10 precise data points with the simple squeeze of the trigger
- Offers 7 additional user-defined data points, all visible on the user-friendly color touch screen and transferable to Excel, Google and GIS software

922 Sign Retroreflectometer™
I3-7-2A

922 Sign Retroreflectometer™
RENTALR3-7-2A

922 Extension Pole

I3-7-2-3

Enables quick and easy measurements of overhead signs. Extends up to 15 feet.



RETROREFLECTIVITY ASSESSMENT SOLUTIONS

FEATURE



PRODUCT

932 Multi-Geometry Retroreflectometer

932 Retroreflectometer™

RoadVista

The 932 retroreflectometer has continuously variable entrance and observation angles designed for use primarily in the laboratory. It measures nighttime color of road signs, high visibility safety clothing and other materials.



Features:

- Measures all types of retroreflective materials with a single measurement
- Meets ASTM, CIE, ANSI, BS, EN & DIN specifications
- Continuously Variable observation angle from 0.2° to 2.0°
- Continuously Variable entrance angle from -45° to +45°
- World-class photopic-corrected detector and source "A"
- Requires only 1 reference standard without any correction factors
- Self-contained commercially available battery or mains power
- Graphical TFT-color touch-screen display
- Built-in Bluetooth Wireless Capability
- USB Computer Interface
- Built-in averaging
- Internal storage for more than 32,000 measurements
- Foam-lined carrying case



932 Retroreflectometer™ I3-7-3A

932 Retroreflectometer™ RENTALR3-7-3A

RPM 1200K™ Reflective Pavement Marker Retroreflectometer™

RPM 1200K is the next generation retroreflectometer designed for use in field measurements of raised retroreflective pavement markers. It is designed to measure the retroreflection (RI) of all RPMs.

- Quickly and accurately measures all types of raised pavement markers, including RRPM's (Cat Eyes) Meets ASTM, CIE & DIN specifications
- Internal GPS, Bluetooth and printer for on-site printing
- Safety swivel handle for taking edge line readings from the shoulder, away from traffic
- Stabilizer bar easily locks into place allowing quick setup and is magnetically held in upright position for simple transportation & storage
- Durable case with precision laser cut foam, pressure release valve for air travel

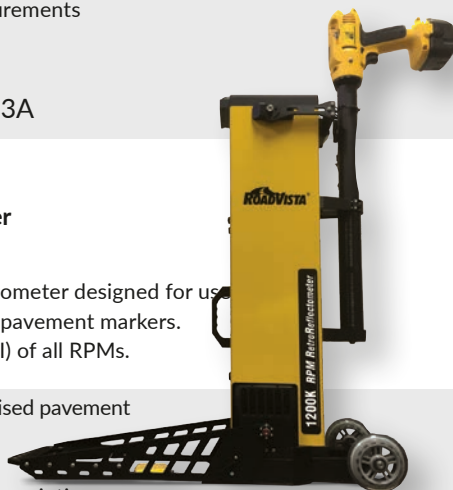

I2-9-7-4-1200K

RETROREFLECTIVITY ASSESSMENT SOLUTIONS

Certified Test Panel Pavement Marking Retroreflectorometer

Certified Test Panel™

The Certified Test Panel instantly provides in field confirmation of the measurement accuracy of pavement marking retroreflectorometers. ENSURE ACCURACY. **SaferRoads, LLC.**



Safe

- Superior assurance that equipment is accurately measuring pavement markings' nighttime visibility
- Safe transportation in a convenient foam-lined, rigid storage/carrying case.



Smart

- The CTP instantly provides in field confirmation of the measurement accuracy of pavement marking retroreflectorometers



Simple

- Confidently maintain the instruments condition and accuracy on a routine basis
- Ensure instruments accuracy and technical conformance

Multi Retroreflectorometer Compatibility

Works with most Retroreflectorometers



In Field Confirmation For Retroreflectorometers



Essential Data Aids in Instrument Calibration Report



Proven Durability 1000s of units in the field



- The 25"x6" Certified Test Panel is the industry's only pavement marking panel on the market with traceable calibration to the National Institute of Standards Technology, calibrated in full conformance with ISO/IEC 17025 requirements.
- The Certified Test Panel can be used with both Stripemaster and LTL series Pavement Marking Retroreflectorometers.
- Verifies instrument's conformance to ASTM E1710 requirements.

- Unlike manufacturer calibration devices, the CTP confirms the optical alignment of the retroreflectorometer to ensure it will provide accurate measurement of horizontal pavement markings, regardless of the equipment's make or calibration settings.
- Easy to transport in form-fitted case complete with certification papers.



Certified Test Panel-12-9-7-4-CTS

| | |
|----------------------------------|--------------|
| 1200k | 20 |
| 922 | 19 |
| 932 | 20 |
| C | |
| Certified Test Panel | 21 |
| L | |
| LaneAlert 2x | 13 |
| LaserLux G7 | 16-17 |
| M | |
| MedianAlert | 8 |
| Modular Median | 6-7 |
| O | |
| Orca | 11 |
| P | |
| PostAlert 2 | 14-15 |
| PostAlert 4 | 14-15 |
| R | |
| RediMat Duo | 5 |
| RediMat..... | 5 |
| Reflective Rumble Strips | 10 |
| S | |
| SiteCop | 10 |
| SiteCop Plus | 10 |
| Stripemaster 1 Touch | 18 |
| StripeMaster 2 Touch | 18 |
| StripeMaster 2 Touch Color | 18 |
| T | |
| Technoflex Speed Bump | 12 |
| TraffiCop | 9 |

COMPANY TIMELINE

PPP 1996-2018

What we do: PPP is a family-owned business with global impact. Having been in business for more than 20 years, PPP is an industry leader in roadway safety solutions. We have distributed more than 800 different products to 1,200+ cities, 50 states and over 75 countries.



PPP First opens in Jacksonville in 1996



Orlando, FL
Opens its doors in 2002



ProStripe Plus Paint
introduced in 2003



Introduced Traffic Trap
Management System™ in 2003



Houston, TX
Opens its doors in 2006



Introduced
Prostripe MX™ in 2006

1996

- PPP begins on the back porch office at Driskell's home
- Joined American Traffic Safety Services Association

1997

- PPP's first branch opens in Jacksonville, FL
- Introduced Prostripe Paint™
- Joined American Traffic Safety Services Association

2002

- New branch opens in Orlando, FL

2003

- Entered into Detectable Warnings market
- Entered into Retroreflective Technologies market
- Introduced Prostripe Plus Paint™
- Introduced Traffic Trap Management System™
- Joined American Public Works Association

2006

- New branch opens in Houston, TX
- Introduced Prostripe MX

2007

- Catalog of 600+ products



2009

- Introduced Medallion Pavement Maintenance Products™
- Introduced ZoomFlex™ Engineers
- Joined CLT
- New branch opens in Charlotte, NC
- New branch opens in Raleigh, NC



Introduced Medallion Pavement Products™ in 2009

2012

- Introduced the Online DAFScale™

2013

- Began PPP Product Development Program

2014

- Introduced and patented MedianAlert™
- Introduced the AlertBrands™ product line



Raleigh, NC
Opens its doors in 2009

2015

- Introduced the PostAlert™
- Introduced the LaserLux G7™
- Joined C12 Group
- Reached 10,000 gallons of sealer sold



Introduced AlertBrands™ product line in 2014

2016

- PPP celebrates its 20th Anniversary
- Introduced Barrier Alert™



2017

- Now carrying over 800+ products!
- New branch opens in Tulsa, OK
- Introduction of LaneAlert 2x™



Carrying over 800+ products in 2017

2018

- Gem Seal acquires Pavement Maintenance Division



Tulsa, OK
Opens its doors in 2017

OUR VALUES AND BELIEFS



What we do?

PPP is a family-owned business with global impact. Having been in business for more than 20 years, PPP is an industry leader in roadway safety, construction and maintenance solutions. We have distributed more than 800 different products to 1,200+ cities, 50 states and 75+ countries. We have served over 19,000 customers and have completed over 185,000 transactions.

Why we do it?

The company's mission is simple, "Build a great company for an even greater cause!" That greater cause is in part the expression of its core values of Honoring, Serving, Impacting, Growing and Innovating. But moreover, it is the aggregate of the greater causes of each of it's employees, customers and vendors.

What we promise?

The company's brand promise is built on its foundations of Products, Service and Knowledge. Products that we design, develop and deliver. Service to our employees, customers, vendors and communities. Knowledge that we seek, learn, and share.

What we believe?

PPP is a Christian-based business. Meaning that we believe that all we receive and achieve is by the grace of God and should be used to glorify Him. Not meaning that all employees are Christian or even that we will always do or respond in the right way. Therefore, we urge you to hold us accountable if ever our actions are inconsistent with this foundation.

INDUSTRY ASSOCIATIONS



ATSSA

American Traffic Safety Services Association represents the road safety, traffic safety, and highway safety industry with effective legislative advocacy, traffic control safety training, and a far-reaching member partnership.

APWA

The American Public Works Association (APWA) serves professionals in all aspects of public works—a fact that sets it apart from other organizations and makes it an effective voice of public works throughout North America. With a worldwide membership over 28,500 strong, APWA includes not only personnel from local, county, state/province, and federal agencies, but also private sector personnel who supply products and services to those professionals.



C12 Group

The C12 Group has become the trusted authority on incorporating business best practices with the foundation of Biblical principles and core values. Business leaders from multiple industries convene monthly for a time of mutual sharpening, high-impact learning, and growth as stewards and Ambassadors for Christ in the marketplace. The C12 experience is accompanied by world-class curriculum and resources curated by top business and ministry leaders.

ITE

The Institute of Transportation Engineers (ITE) is an international membership association of transportation professionals who work to improve mobility and safety for all transportation system users and help build smart and livable communities. Through its products and services, ITE promotes professional development and career advancement for its members, supports and encourages education, identifies necessary research, develops technical resources including standards and recommended practices, develops public awareness programs, and serves as a conduit for the exchange of professional information.



CHARITIES WE SUPPORT AT PPP

ATSSA Foundation (ATSSA Foundation Golf Tournament Sponsor)

The American Traffic Safety Services Foundation (The Foundation) exists to promote roadway safety through charitable giving and public awareness programs

Campus Crusade for Christ

Helping to fulfill the Great Commission in the power of the Holy Spirit by winning people to faith in Jesus Christ, building them in their faith and sending them to win and build others; and helping the Body of Christ do evangelism and discipleship

Christ in Youth

Christ in Youth amplifies the call on students' lives to become Kingdom workers through trips, events, and resources

City Rescue Mission

City Rescue Mission exists to transform the lives of the homeless and needy, serving them through the love and compassion of Jesus Christ

Crohns and Colitis Foundation

The Crohn's and Colitis Foundation is a non-profit, volunteer-driven organization dedicated to finding the cures for Crohn's Disease and ulcerative colitis, and to improving the quality of life of children and adults affected by these diseases

Florida Baptist Children's Homes-Porch Light Project

The Porch Light Project is a ministry of Florida Baptist Children's Homes that is meeting the desperate need for safe homes for child victims of domestic sex trafficking

Institute for Worship Studies

The Institute for Worship Studies is a unique graduate school offering Master of Worship Studies and Doctor of Worship Studies degrees that combines the best of on-campus learning and long-distance interactivity to form servant leaders in Christian worship

Legacy of Care

At Legacy of Care Health Center, our mission is to provide free medical care and health promotion services to all uninsured and underinsured adults through disease management, preventative education and health screening by volunteer professionals for the purpose of building a healthy community

Operation Blessing International Relief and Development Corporation

Operation Blessing International Relief and Development Corporation (OBI) is a 501(c)(3) nonprofit, humanitarian organization headquartered in the United States. One of the largest charities in America, Operation Blessing provides strategic relief in 39 countries around the world on an ongoing basis. Through core programs of disaster relief, medical aid, hunger relief, vulnerable children and orphan care, clean water, and community development, OBI is dedicated to demonstrating God's love by alleviating human need and suffering in the United States and around the world

Rapha House

Our mission is to end the trafficking and sexual exploitation of children through aftercare for survivors, prevention for the vulnerable, and awareness for all

Rethreaded

Our mission at Rethreaded is a social entrepreneurship that is breaking the cycle of the sex trade by offering viable and creative work to those affected by the sex trade. We are fighting the business of the sex trade with business. We believe that the sex trade can steal a person's identity, worth, and value. We seek to be an organization that offers a chance for people to experience, learn and grow into the fullness of who they are

Salvation Army

The Salvation Army is an integral part of the Christian Church, although distinctive in government and practice. The Army's doctrine follows the mainstream of Christian belief and its articles of faith emphasize God's saving purposes. Its objects are 'the advancement of the Christian religion... of education, the relief of poverty, and other charitable objects beneficial to society or the community of mankind as a whole.*'

St. Jude's Children Hospital

St. Jude is leading the way the world understands, treats and defeats childhood cancer and other life-threatening diseases

ORDERING INFORMATION



Call Toll Free: 888.717.7771



Visit: www.pppcatalog.com



Email: info@pppcatalog.com

3 Ways to Pay:

1) Payment at Time of Purchase:

- Credit cards (American Express, Discover, MasterCard, Visa)
- Business check (if set up as a customer in our system)
- Personal Check with proper Identification (if set up as a customer in our system)
- Cash

2) House Account:

A House Account may be established with an approved credit application. The House Accounts' purpose is for the purchasing of small projects or items that do not become part of the property being improved. This account has a strict limit and terms.

- House Account terms are net 30 days – no payment discounts are available
- Purchase must not cause House Account to exceed established credit limit
- Finance charges will be assessed on accounts that exceed 30 day terms

3) JobFlex:

JobFlex provides more credit, more security, and more days to pay. A JobFlex account is established for each project, for the purchase of materials used and that become part of the property being improved, "job materials". The JobFlex limits are dependent upon each project's needs and does not effect an established House Account. See www.PPPCatalog.com/JobFlex for more details.

- JobFlex program is a way to expand your available credit for jobs without affecting your established House Account limit
- Terms for JobFlex are net 45 days
- A separate JobFlex is established for each "Lienable" or bondable Project.
- Materials purchased on JobFlex must become part of the property improvement and are not for general inventory

Ordering Terms:

Due to the complexity of shipping involved with a mass majority of our products and our desire to get our customers the best possible pricing available, we do not provide online pricing. You may submit a quote online and a PPP representative will work with you to get the best pricing possible with freight included, or simply call toll free (888.717.7771) during normal business hours (Monday-Friday, 8 a.m. – 6 p.m. eastern) to place your order. In many instances, next day delivery to your place of business or jobsite may be available

- Orders must be received by 2 p.m. eastern, Monday – Friday, to be eligible for same day shipping
- Next day delivery is not guaranteed
- Items are shipped Parcel or LTL motor freight – whichever will benefit you the most!
- Prices, brands and specifications are subject to change
- Orders with shortages or damages must be reported to PPP within 48 hours of receipt of goods – inspect all goods upon delivery – notate all discrepancies on the carrier delivery ticket and on your copy; ensure both copies are signed by the driver; and notify us immediately
- All refunds/returns require the original invoice/packing slip, and the product must be in original condition with original packing
- Refunds can only be issued within (30) thirty days of receipt of product
- There are no refunds on special orders, equipment, or parts
- Returns on product purchased by credit card will be assessed the appropriate processing fees as charged by the credit card company – this applies to the original purchase and the return
- All returns are subject to a minimum 15% restocking fee and return freight charges are the responsibility of the buyer

Copyright © 2018 PPP. All rights reserved.
Reproduction of any of this catalog and its accompanying materials is strictly prohibited without the written permission of PPP.

SPIRITUAL REFLECTION

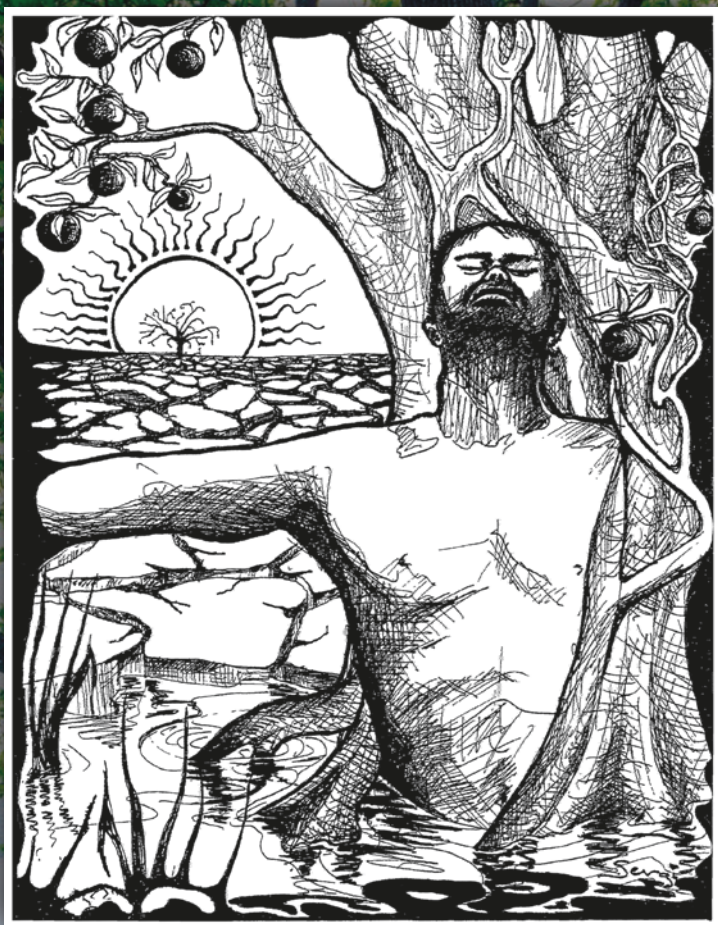

*Blessed is the man who trusts in the Lord
whose confidence is in Him.*

*He will be like a tree planted by the water
that sends out its roots by the stream.*

*It does not fear when heat comes its leaves are always green.
It has no worries in a year of drought and never fails to bear fruit.*

Jeremiah 17 7



PPP

Transportation Safety Innovations

9556 Historic Kings Rd. S., Suite #401
Jacksonville, FL 32257

888.717.7771

WWW.PPPCATALOG.COM

Proud Member:

